

SCUPPER THROUGH ROOF EDGE

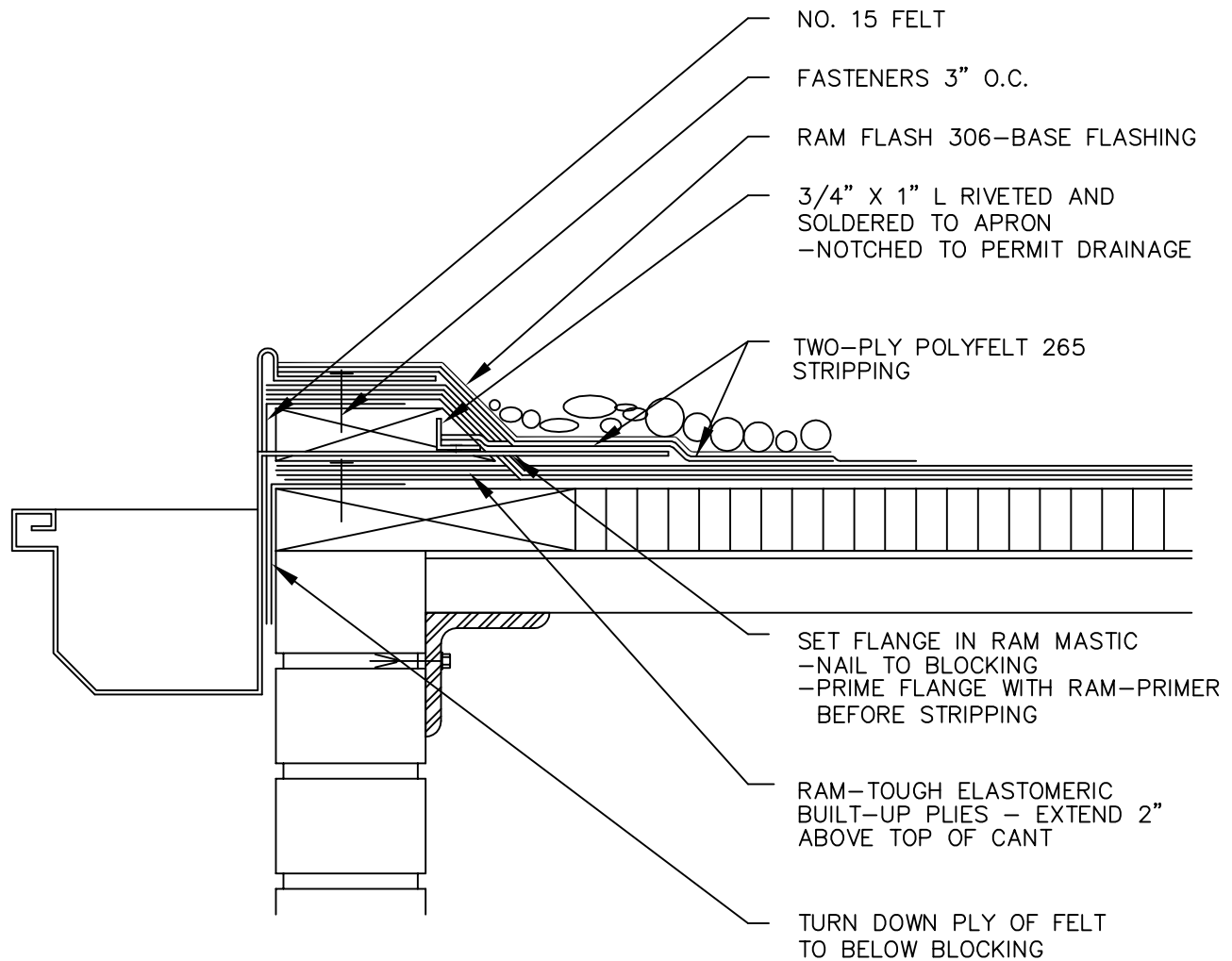

NOTES:

1. THIS DETAIL SHOULD BE USED ONLY WHERE THE DECK IS SUPPORTED BY THE OUTSIDE WALL.
2. THIS DETAIL CAN BE ADAPTED TO ROOF EDGES SHOWN IN DETAILS 'B' AND 'C' AND IS EASY TO INSTALL AFTER THE BUILDING IS COMPLETED. THIS DETAIL IS USED TO RELIEVE STANDING WATER IN AREAS ALONG THE ROOF EDGE. ALL ROOF SURFACES SHOULD BE SLOPED TO DRAIN.
3. ATTACH NAILER TO MASONRY WALL. REFER TO FACTORY MUTUAL DATA SHEET 1-49.
4. WOOD BLOCKING MAY BE SLOTTED FOR VENTING WHERE REQUIRED.



BARRETT COMPANY
 BRT-ASEC.DWG
 FOR TECHNICAL ASSISTANCE
 CALL 1-800-647-0100