

NOTES:  
 1. WHEN INSTALLING METAL BASE FLASHING, EXTEND PROTECTION COURSE UP THE WALL IN RAM-TOUGH 250, COVERING THE NEOPRENE FLASHING SHEET, PRIOR INSTALLING METAL FLASHING.

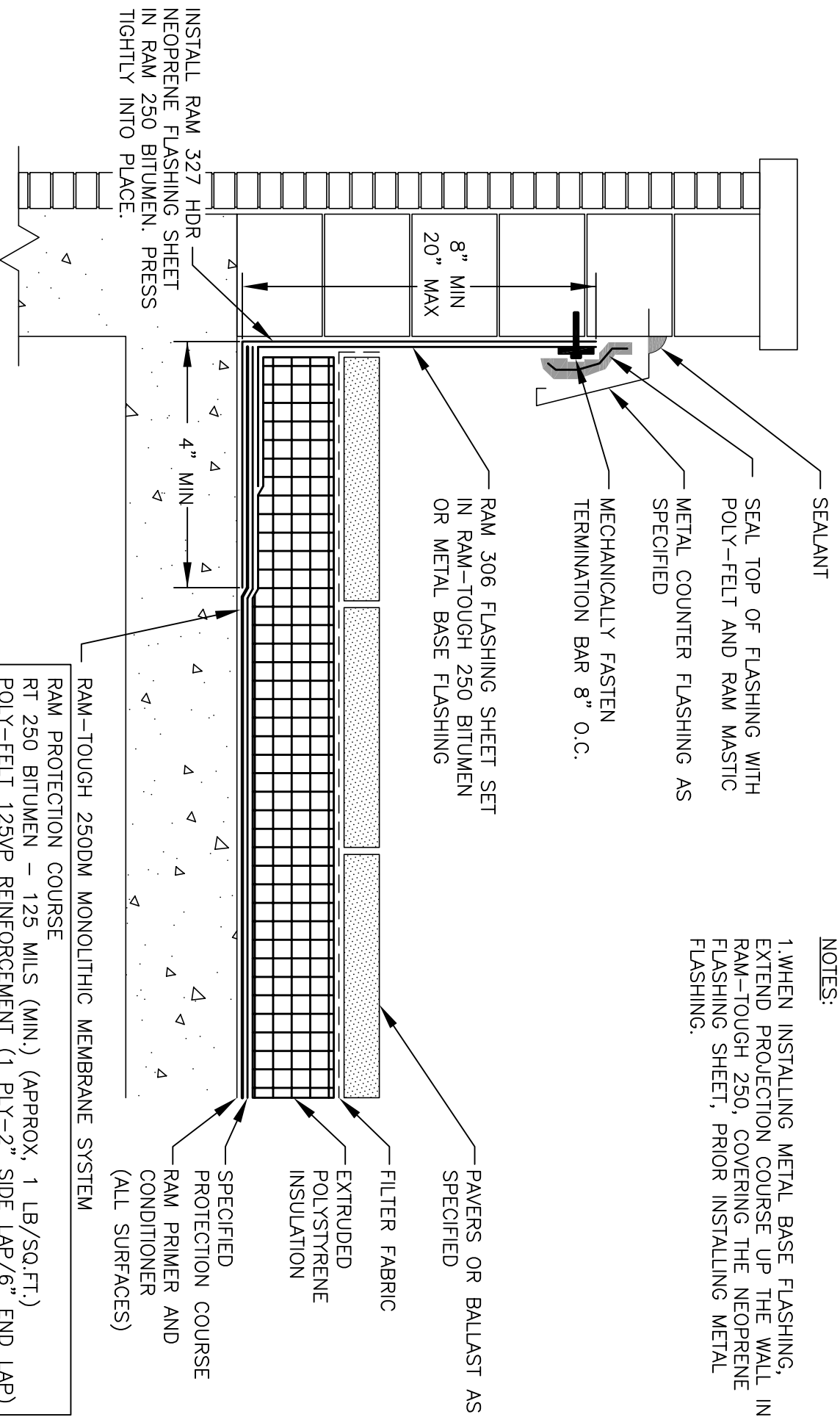

INSTALL RAM 327 HDR NEOPRENE FLASHING SHEET IN RAM 250 BITUMEN. PRESS TIGHTLY INTO PLACE.

8" MIN  
20" MAX

4" MIN

RAM-TOUGH 250DM MONOLITHIC MEMBRANE SYSTEM  
 RAM PROTECTION COURSE  
 RT 250 BITUMEN - 125 MILS (MIN.) (APPROX. 1 LB./SQ.FT.)  
 POLY-FELT 125VP REINFORCEMENT (1 PLY-2" SIDE LAP/6" END LAP)  
 RT 250 BITUMEN - 90 MILS (MIN.) (APPROX 0.7LBS./SQ.FT.)



Between the World and The Weather Since 1928

RAM-TOUGH 250DM WATERPROOFING SYSTEMS

BASE FLASHING AT NON-MONOLITHIC POURED WALL (DRAWING NOT TO SCALE)

DATE ISSUED: 09/08

DRAWING NUMBER: RT250-05